

Go Beyond

the limits of traditional
medical covers



Medical package monthly subscriptions



Premium
695/=

- ✓ Unlimited consultations
- ✓ Personal team of 3 doctors (1 GP, 2 Specialists)
- ✓ 1 Health and wellness report/year
- ✓ 5% discount on all outpatient care services, referrals and medication
- ✓ 1 emergency evacuation/year



Elite
1695/=

- ✓ Unlimited consultations
- ✓ Personal team of 3 doctors (1 GP, 2 Specialists)
- ✓ 1 Health and wellness report/year
- ✓ 5% discount on all outpatient care services and referrals
- ✓ 2 emergency evacuations/year
- ✓ **Full cover:** Prescription+OTC medications, no limit
- ✓ 1 Health checkup/year



Beyond
2495/=

- ✓ Unlimited consultations
- ✓ Personal team of 3 doctors (1 GP, 2 Specialists)
- ✓ 1 Health and wellness report/year
- ✓ **Unlimited outpatient care** including diagnostics, labs, and more
- ✓ **Unlimited emergency evacuations**
- ✓ **Full cover:** Prescription+OTC medications, no limit
- ✓ 1 Health checkup/year

Family Discounts

Duo (2) – 5% off for all subscribers

Trio (3) – 10% off for all subscribers

Quad (4) – 15% off for all subscribers

Penta (5) – 20% off for all subscribers

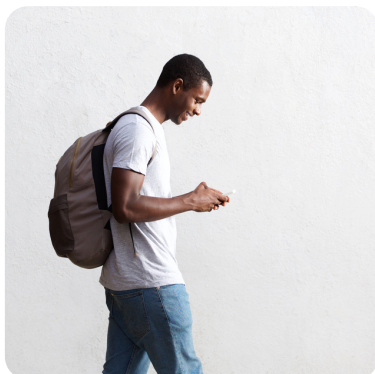

*12-month subscription required
Waiting period 30 days!

Designed for you and your family

Above and beyond your medical needs

Unlimited

- No annual fees.
- No limits.
- Get unlimited access to outpatient medical services.

Flexible payments

Pay Monthly

24/7 access

Talk to doctors
anywhere, anytime!

Everything online

Doctors, medication, lab tests
all on your phone.

Zero waiting times

Access doctors within 15
minutes



Free Symptom
Check-ups



Talk to doctors
24/7



Health
Records

All-In- One Medical Package

YOUR HEALTH MATE

Health is the new wealth

We have learned that protecting your health and well-being is vital because we believe that being in good health is a new wealth. That's why our Medical Package solution is designed for you and your family, so you can make the most of it.

3 steps to an Affordable Medical Package

1. Download app
2. Register
3. Pay

HOW TO ACCESS THE MEDICAL PLAN IN THE APP

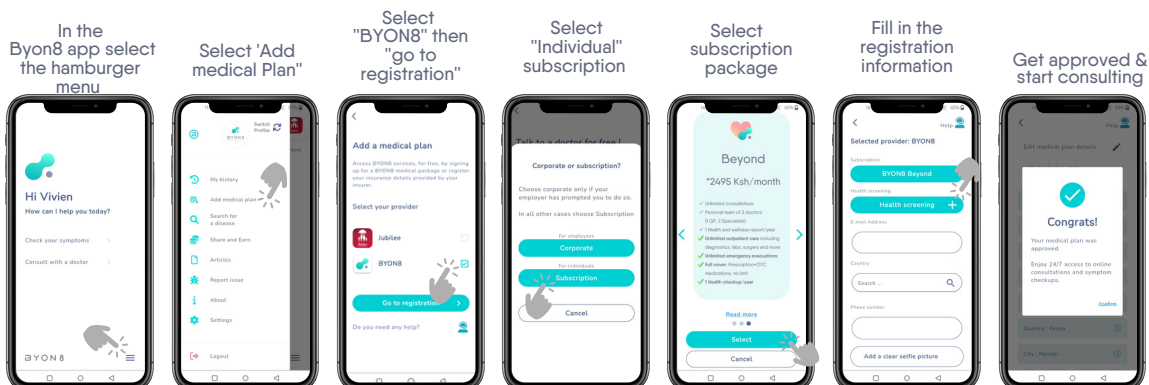

Online - no more cards

Seamless!

Online - no more cards

You will never need a card again!

The medical plan is stored and saved online. You can use it both online and at any of our referral facilities to access outpatient services.

Enjoy all BYON8 services

- Specialists and GP's available online, 24/7
- Prescriptions and medication
- Medical investigation (Labs, x-ray, etc.)
- Access to >100 partner healthcare facilities and pharmacies
- Whatever you need - our outpatient services will cover it!

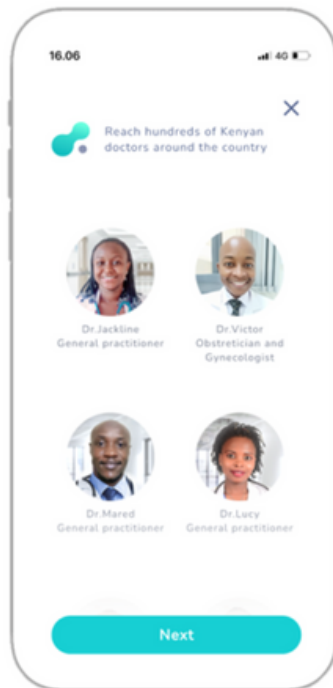

Online doctors 24/7

Talk to a doctor, therapist, or medical expert anywhere you are by phone or video

Subscription payment benefits

Quarterly - Get 5% discount

Half-year - Get 7.5% discount

Yearly - Get 10% discount

OUR REFERRAL NETWORK

You can access any of our clinics, laboratories and pharmacies

Meridian Health
GROUP

ILARA HEALTH

MARIE STOPES
INTERNATIONAL

rescue.co

HALCYON
HEALTH CARE CENTRE

MYDAWA
mPower your health



Poplar
Hospital

Imperio
MEDICAL



SYS-PHARMA

NIM HEALTH
Advancing Medicine. Transforming Lives.

iviva

Convergent
Medical
Services



Kasha

MENORAH HOSPITAL
Westlands Medical Center
Bringing New Life Experience

Our doctors will always refer you to the most convenient facility for physical examination whenever needed. Some of our partner health facilities include; Marie Stopes International, Ilara Health, Kasha, Jitunze Wellness, Halycon Medical Center, Poplar hospital, NIM Health, Trinity Health, MyDawa, SysPharma, Jionee Diagnostics, Quest Lab, Imperio Medical Group, Rescue Ambulances, Menorah Hospital among others.

Eligibility to join

- A principal member who is yet to attain the age of 60 years.
- A spouse who is yet to attain the age of 60 years.
- The child or dependent stepchild or legally adopted child from birth provided it is born at full term at 38 weeks and under 18 years of age upon receipt of relevant documentation pertaining to proof of dependency of the child or depend

BYON8 AB

The Promenade, 3rd Floor
General Mathenge Rd,
Nairobi KENYA
Tel: + 254 743 710 145
Email:

Software.support@byon8.com
www.Byon8.com